

REVISION RECORD				
REV	ECD	DESCRIPTION	DATE	DFT/APP'D
A	-	Initial production release	03/08/17	MSW

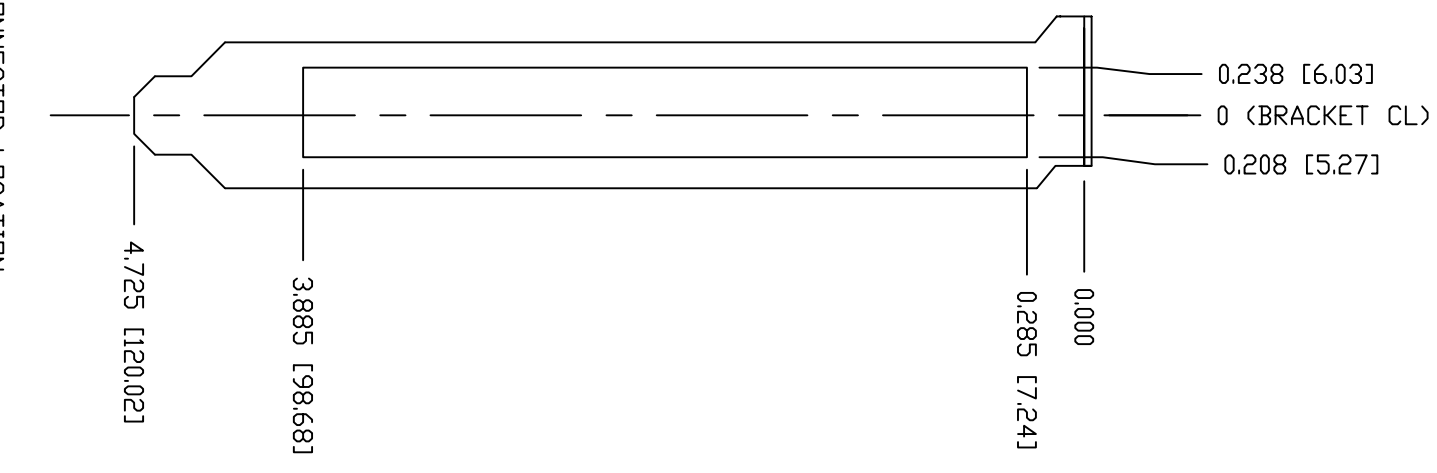

CONNECTOR LOCATION

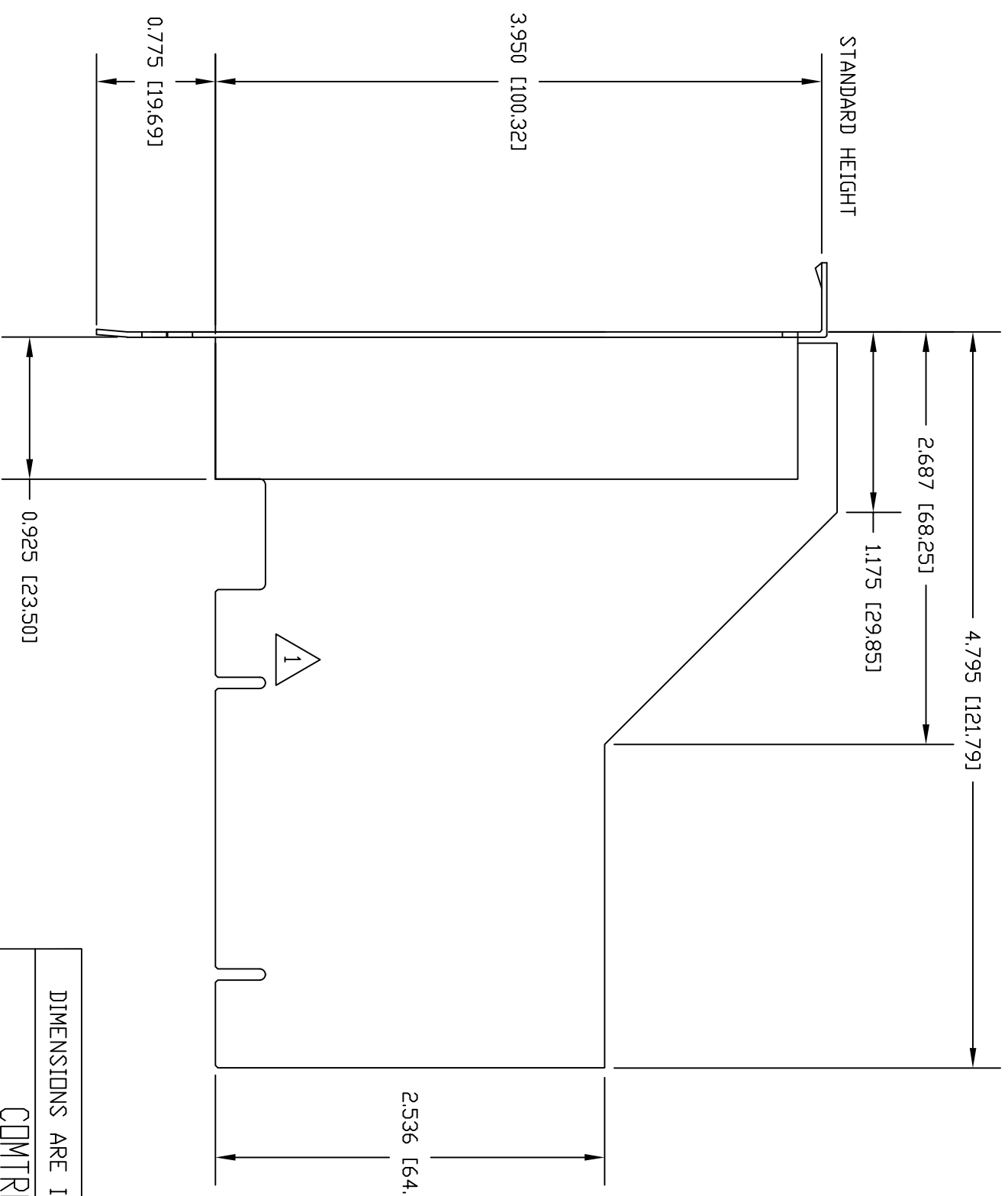

NOTES:

1. FOR MORE DETAILED DIMENSIONS, REFER TO PCI CARD ELECTROMECHANICAL SPECIFICATION, REV 1.0A.

DIMENSIONS ARE IN INCHES [MM]											
CONTROL CORP.											
TITLE ROCKETPORT INFINITY, 8J											
30027-4											
FILENAME	30027-4_RP_INFINITY_8J_A.DWG	SIZE	B	BY	MSW	DATE	03/08/17	REV	A	SHEET	1 OF 1